



REGIONAL DISTRICT OF ALBERNI-CLAYOQUOT

BYLAW NO. P1535

OFFICIAL ZONING ATLAS AMENDMENT NO. 802

A bylaw of the Regional District of Alberni-Clayoquot to amend Bylaw No. 15, being the “Regional District of Alberni-Clayoquot Zoning By-law No. 15, 1971”.

WHEREAS the *Local Government Act* authorizes the Regional Board to amend a zoning bylaw after a public hearing and upon the affirmative vote of the directors in accordance with Sections 464, 465, 470 and 479 of the *Local Government Act*;

AND WHEREAS an application has been made to rezone a property;

NOW THEREFORE the Board of Directors of the Regional District of Alberni-Clayoquot, in open meeting assembled, enacts the following amendment to the Official Zoning Atlas of the Regional District of Alberni-Clayoquot Zoning By-law No. 15, 1971:

1. TITLE
This bylaw may be cited as the Regional District of Alberni-Clayoquot Zoning Atlas Amendment Bylaw P1535.
2. Bylaw No. 15 of the Regional District of Alberni-Clayoquot is hereby amended by rezoning: DISTRICT LOT 272 ALBERNI DISTRICT EXCEPT PART IN PLAN 149 RW from “Rural (A2) District” to a mix of “Light Industrial (M2B) District” and “Mixed Accommodation Commercial (MAC) District” as shown on Schedule ‘A’ which is attached to and forms part of this bylaw.
3. This bylaw shall come into force and take effect upon the adoption thereof.

Read a first time this	day of	,
Public Hearing held this	day of	,
Read a second time this	day of	,
Read a third time this	day of	,
Adopted this	day of	,

Corporate Officer

Chair of the Regional Board

Schedule 'A'

This schedule is attached to and forms part of Regional District of Alberni-Clayoquot Zoning Atlas Amendment Bylaw P1535, 2026

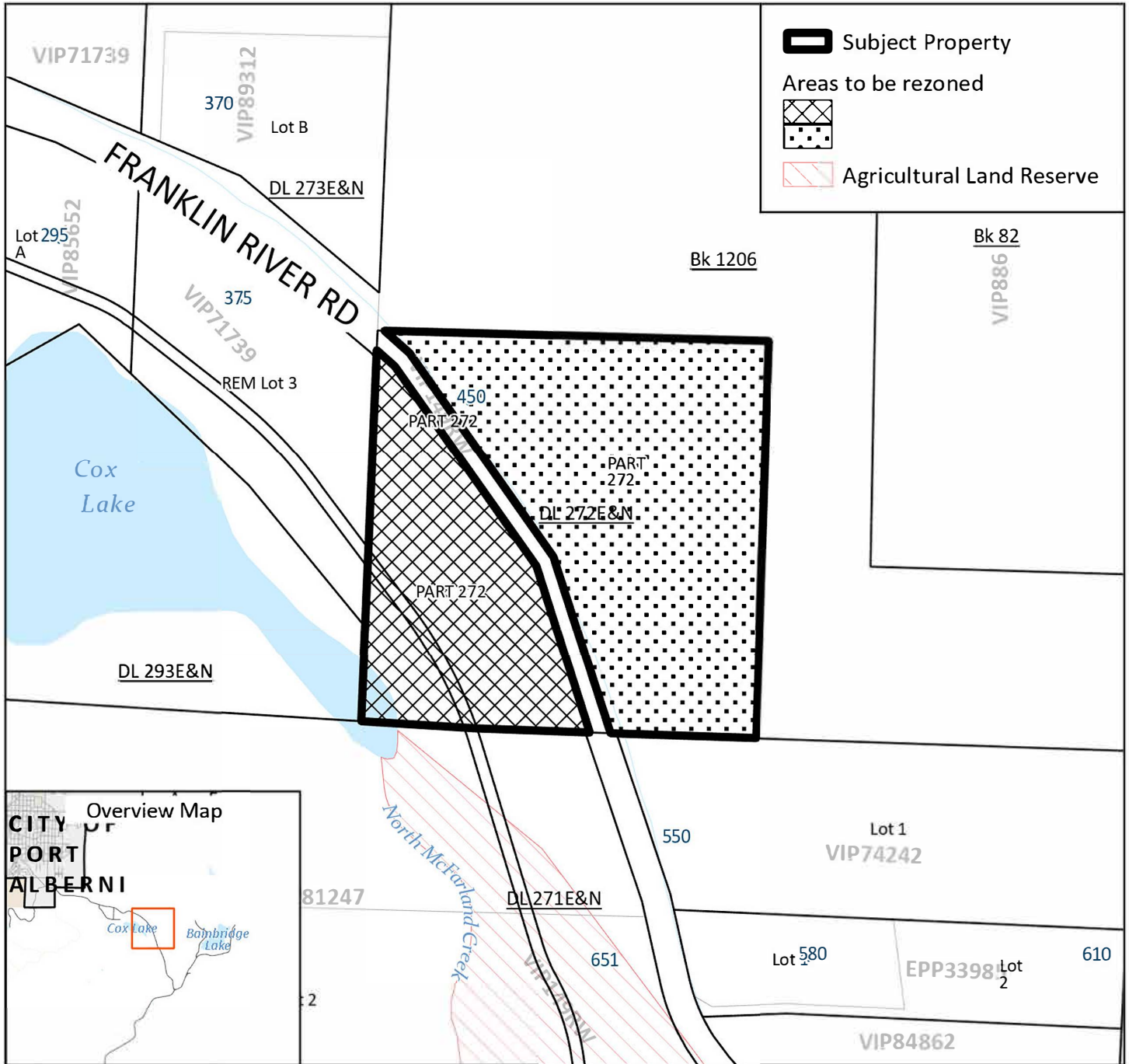

Legend

- Subject Property
- Areas to be rezoned
- Agricultural Land Reserve

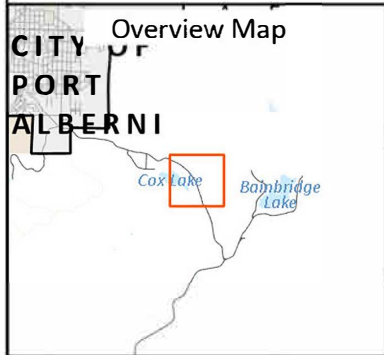

Legal Description: DISTRICT LOT 272 ALBERNI DISTRICT EXCEPT PART IN PLAN 149 RW

Address: 450 Franklin River Road

To be rezoned from Rural (A2) District to Mixed Accommodation Commercial (MAC) District.

To be rezoned from Rural (A2) District to Light Industrial (M2B) District.

