



REGIONAL DISTRICT OF ALBERNI-CLAYOQUOT

BYLAW NO. P1533

**A BYLAW TO AMEND BYLAW NO. P1278
ELECTORAL AREA F - CHERRY CREEK OFFICIAL COMMUNITY PLAN**

WHEREAS by Section 478(2) of the *Local Government Act*, all bylaws enacted by the Regional Board must be consistent with an existing official community plan;

AND WHEREAS the Regional Board may amend an existing official community plan;

NOW THEREFORE the Board of Directors of the Regional District of Alberni-Clayoquot in open meeting assembled enacts as follows:

1. TITLE
This bylaw may be cited as the Cherry Creek Official Community Plan Amendment Bylaw No. P1533.
2. Schedule A, Map 2, Land-Use Designations map, is hereby amended by redesignating DISTRICT LOT 272 ALBERNI DISTRICT EXCEPT PART IN PLAN 149 RW from “Rural Use” to a mix of “Industrial Use” and “Commercial Use” as shown on Schedule ‘A’ which is attached to and forms part of this bylaw.
3. Schedule A, Map 3, Development Permit Areas and Development Approval Information Areas map, is hereby amended by including DISTRICT LOT 272 ALBERNI DISTRICT EXCEPT PART IN PLAN 149 RW within “Development Permit Area (DPA) III – Objectives for Form and Character” as shown on Schedule ‘B’ which is attached to and forms part of this bylaw.
4. This bylaw shall come into force and take effect upon the adoption thereof.

Read a first time this	day of	,
Public Hearing held this	day of	,
Read a second time this	day of	,
Read a third time this	day of	,
Adopted this	day of	,

Corporate Officer

Chair of the Regional Board

Schedule 'A'

This schedule is attached to and forms part of the Cherry Creek Official Community Plan Amendment Bylaw P1533, 2026

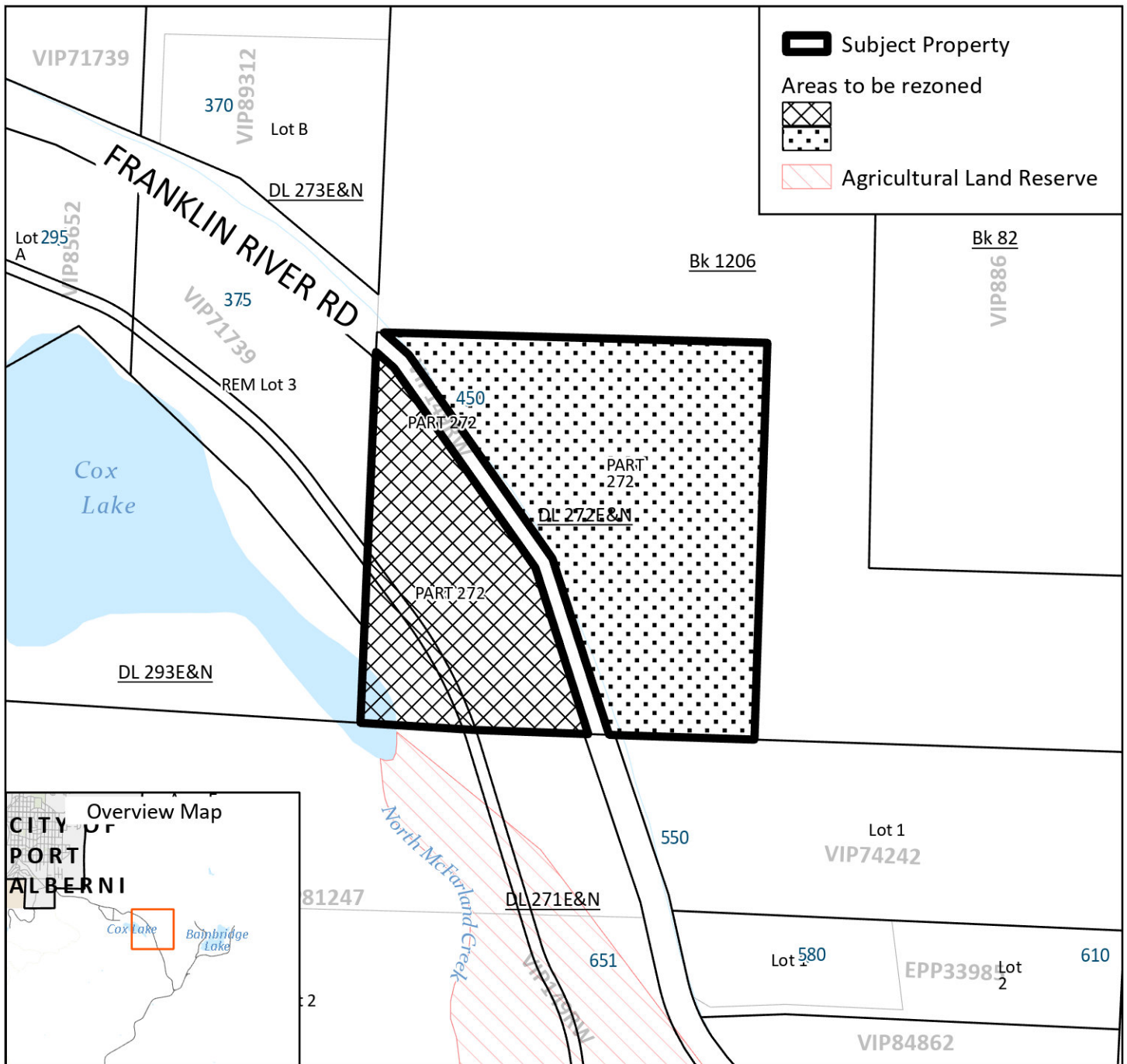

Legend

- Subject Property
- Areas to be rezoned
- Agricultural Land Reserve

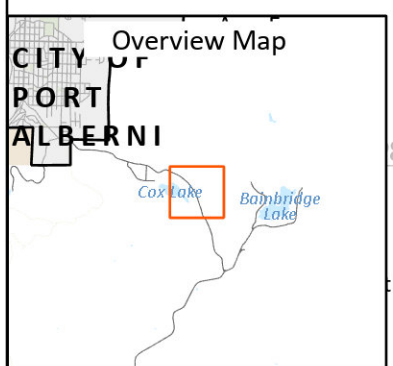

Legal Description: DISTRICT LOT 272 ALBERNI DISTRICT EXCEPT PART IN PLAN 149 RW

Address: 450 Franklin River Road

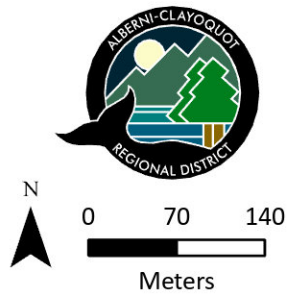

- To be redesignated from Rural Use to Commercial Use.
- To be redesignated from Rural Use to Industrial Use.

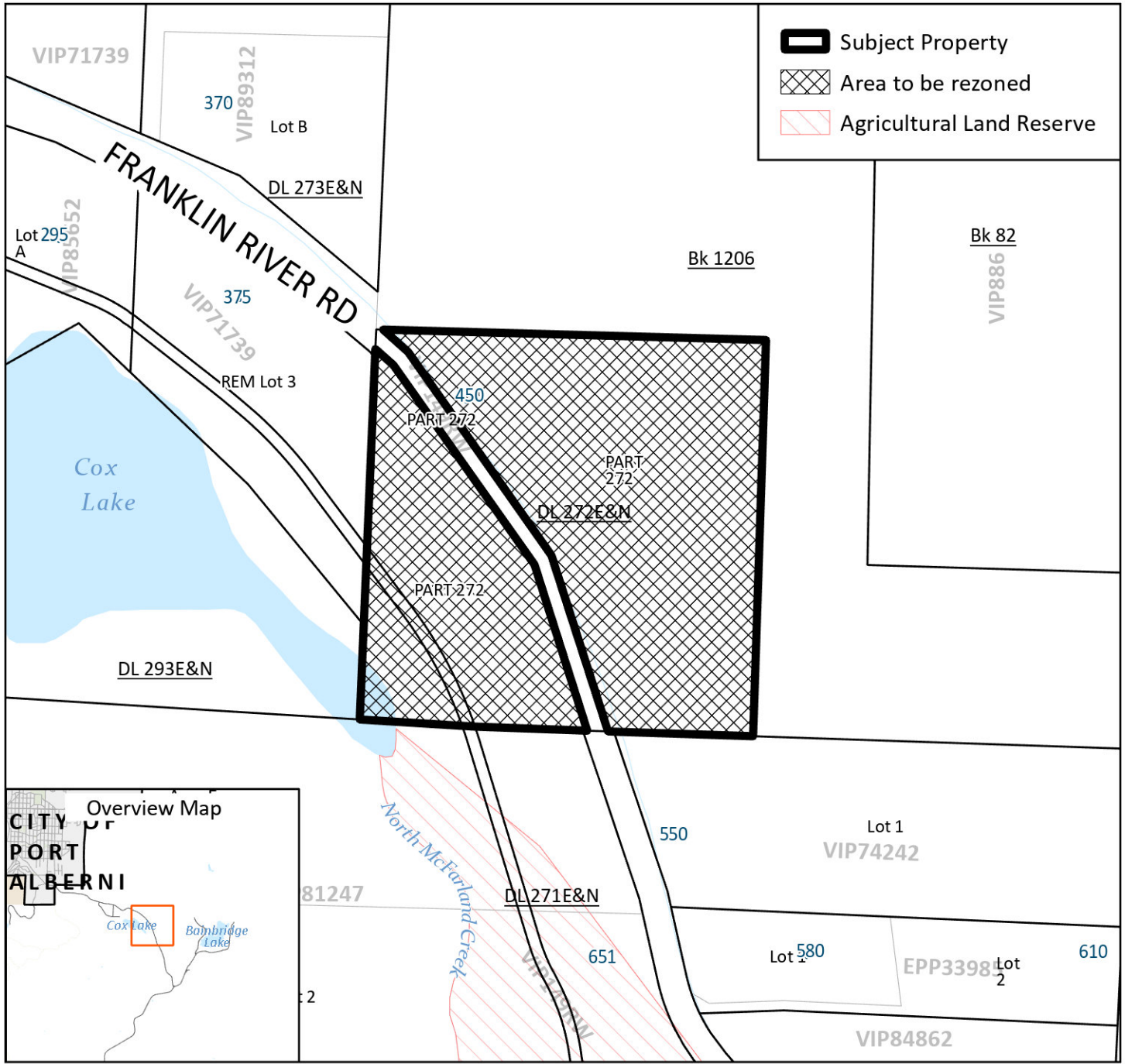

Schedule 'B'

This schedule is attached to and forms part of the Cherry Creek Official Community Plan Amendment Bylaw P1533, 2026



-  Subject Property
-  Area to be rezoned
-  Agricultural Land Reserve

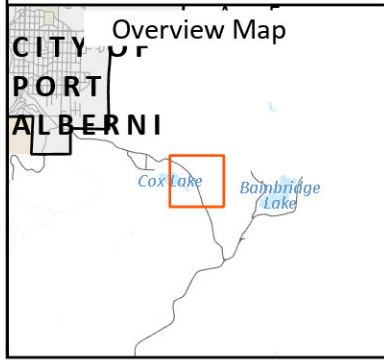

Legal Description: DISTRICT LOT 272 ALBERNI DISTRICT EXCEPT PART IN PLAN 149 RW
 Address: 450 Franklin River Road

 To be included in DPA III - Objectives for Form and Character.

