

REGIONAL DISTRICT OF ALBERNI-CLAYOQUOT
BYLAW NO. P1283
OFFICIAL ZONING ATLAS AMENDMENT NO. 653

A bylaw of the Regional District of Alberni-Clayoquot to amend Bylaw No. 15, being the "Regional District of Alberni-Clayoquot Zoning By-law No. 15, 1971".

WHEREAS the *Local Government Act* authorizes the Regional Board to amend a zoning bylaw after a public hearing and upon the affirmative vote of the directors in accordance with Sections 890 and 894 of the *Local Government Act*;

AND WHEREAS an application has been made to rezone a property;

AND WHEREAS the Board of Directors of the Regional District of Alberni-Clayoquot, in open meeting assembled, enacts the following amendment to the Official Zoning Atlas of the Regional District of Alberni-Clayoquot Zoning By-law No. 15, 1971:

1. TITLE

This bylaw may be cited as the Regional District of Alberni-Clayoquot Zoning Atlas Amendment Bylaw No. 653.

2. Bylaw No. 15 of the Regional District of Alberni-Clayoquot is hereby amended by rezoning: Lot 165, Clayoquot District, containing 152 acres, more or less, except parts in Plans 11182 and 1417 RW. Lot 163, Clayoquot District, except part in Plans 1417RW, 11182 and 32328. Lot 164, Clayoquot District, except parts in Plans 11182 and 1417RW. That Part of DL 166, Clayoquot District, except part in Plan 1417 RW, lying to the north and east of Plan 1417 RW. DL 167, Clayoquot District, containing 160 acres more or less. That part of DL 192, Clayoquot District, except part red on Plan 1417 RW, lying to the north and east of Plan 1417 RW. That part of DL 113, Clayoquot District, lying to the north and east of Plan 1417RW That part of DL 193, Clayoquot District, lying to the east of Plan 1371RW. That part of DL 194, Clayoquot District, lying east of Plan 1371 RW. DL 178, Clayoquot District. DL 168, Clayoquot District. DL 169, Clayoquot District. DL 170, Clayoquot District. That part of DL 196, Clayoquot District, except part in Plan 1371 RW lying to the east of Plan 1371 RW. DL 193, Clayoquot District, except that part lying to the west of Plan 1371 RW. That part of DL 195, Clayoquot District, except part in Plan 1371 RW lying to the east of Plan 1371 RW. from Park and Public Use (P2) District to Long Beach Airport One (APLB1) District and Long Beach Airport Two (APLB2) District as shown on Schedule 'A' which is attached to and forms part of this bylaw.

3. This bylaw shall come into force and take effect upon the adoption thereof.

Read a first time this 24th day of August, 2011
Public hearing held this 17th day of January, 2017
Read a second time this 25th day of January, 2017
Read a third time this 25th day of January, 2017
Adopted this 8th day of February, 2017



Russell Dyson, CAO



Chair of the Regional Board

Schedule 'A'

This schedule is attached to and forms part of Bylaw P1283

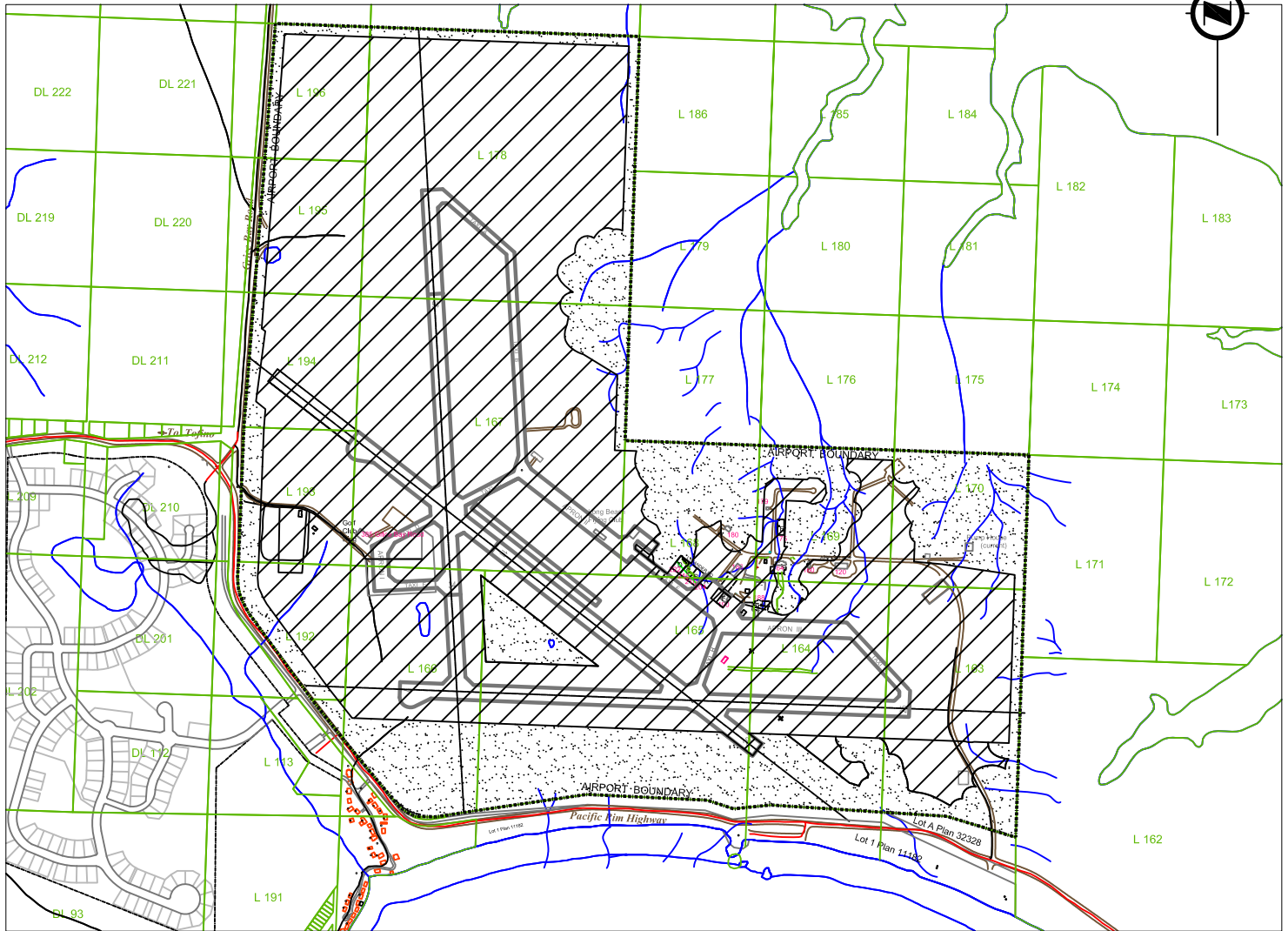

Legal Description: Lot 165, Clayoquot District, containing 152 acres, more or less, except parts in Plans 11182 and 1417 RW. Lot 163, Clayoquot District, except part in Plans 1417RW, 11182 and 32328. Lot 164, Clayoquot District, except parts in Plans 11182 and 1417RW. That Part of DL 166, Clayoquot District, except part in Plan 1417 RW, lying to the north and east of Plan 1417 RW. DL 167, Clayoquot District, containing 160 acres more or less. That part of DL 192, Clayoquot District, except part red on Plan 1417 RW, lying to the north and east of Plan 1417 RW. That part of DL 113, Clayoquot District, lying to the north and east of Plan 1417RW That part of DL 193, Clayoquot District, lying to the east of Plan 1371RW. That part of DL 194, Clayoquot District, lying east of Plan 1371 RW. DL 178, Clayoquot District. DL 168, Clayoquot District. DL 169, Clayoquot District. DL 170, Clayoquot District. That part of DL 196, Clayoquot District, except part in Plan 1371 RW lying to the east of Plan 1371 RW. DL 193, Clayoquot District, except that part lying to the west of Plan 1371 RW. That part of DL 195, Clayoquot District, except part in Plan 1371 RW lying to the east of Plan 1371 RW.



To be rezoned from Park and Public Use (P2) District to Long Beach Airport One (APLB1) District



To be rezoned from Park and Public Use (P2) District to Long Beach Airport Two (APLB2) District



ALBERNI-CLAYOQUOT
REGIONAL DISTRICT

