

G:\211103399-01 Albern Valley Rev 1\ExtmPhase005\Sheet Files\03103399-01 C1.0.dwg [C1.0] April 15, 2015, 3:44:27 pm (B) KLUMDOR, B.L.L.

LEGEND

	RUNWAY EXTENSION AND WIDENING		NON-ILLUMINATED WINDSOCK		PRECISION APPROACH PATH INDICATOR (PAPI)
	PROPERTY LINE		ILLUMINATED WINDSOCK		AIRPORT ROTATING BEACON
	POST & RAIL WIRE FENCE		OVERHEAD POWER		
	CHAIN LINK SECURITY FENCE		POWER CABLES		
	CHAIN LINK FENCE		DUCT BANK		
	STEEL TUBE FENCE		RUNWAY END LIGHTS		
	TOE OF SLOPE		RUNWAY EDGE LIGHTS		
	TOE OF SLOPE		APRON/TAXIWAY EDGE LIGHTS		
	STORM SEWER LINES		APRON ENTRANCE LIGHTS		
	CULVERTS				

Scale: 1:2,500 @ 22"x34"

NUM	DATE	DWN	CKD	APR	REVISIONS	NUM	DATE	APR	DESCRIPTION
1	2015/01/27	T.J.	S.S.	B.K.	UPDATE DRAWING PER CLIENT COMMENTS	B	2015/04/15	BK	ISSUED FOR 95% REVIEW
0	2014/11/12	T.J.	S.S.	B.K.	INITIAL DESIGN	A	2015/01/16	B.K.	ISSUED FOR 90% REVIEW

PERMIT

PROFESSIONAL SEAL

CLIENT

ALBERNI-CLAYOQUOT REGIONAL DISTRICT

TETRA TECH EBA

**RUNWAY EXTENSION DESIGN
ALBERNI VALLEY REGIONAL AIRPORT (CBS8)
PORT ALBERNI, BC**

CIVIL SITE PLAN

PROJECT No.	OFFICE	DES	CKD	REV	DRAWING
C31103399-002	CALGARY	B.K.	S.S.	1	
DATE:	SHEET No.	DWN	APP	STATUS	
APRIL 15, 2015	2 of	T.J.	B.K.	A	

C1.0

GCM PIT

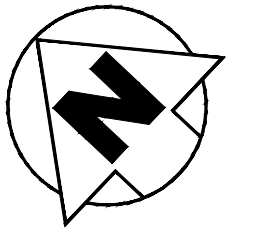

GCM PIT F171

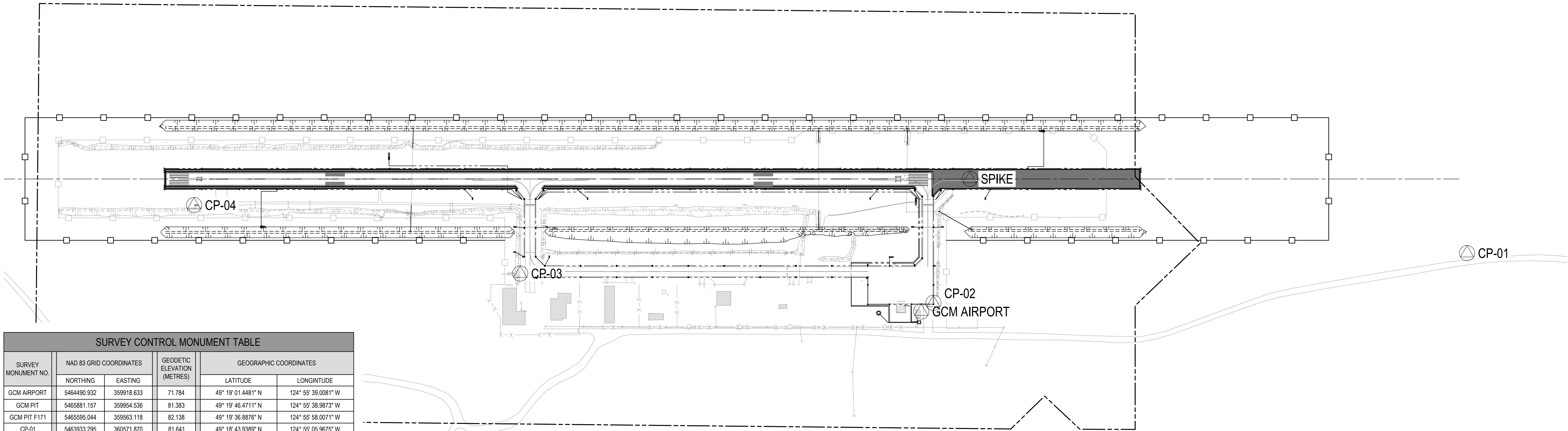

SURVEY MONUMENT NO.	NAD 83 GRID COORDINATES		GEODETTIC ELEVATION (METRES)	GEOGRAPHIC COORDINATES	
	NORTHING	EASTING		LATITUDE	LONGITUDE
GCM AIRPORT	5464490.932	359918.633	71.784	49° 19' 01.4481" N	124° 55' 39.0081" W
GCM PIT	5465881.157	359954.536	81.383	49° 19' 46.4711" N	124° 55' 38.9873" W
GCM PIT F171	5465595.044	359563.118	82.138	49° 19' 36.8876" N	124° 55' 58.0071" W
CP-01	5463933.295	360571.870	81.641	49° 18' 43.9389" N	124° 55' 05.9675" W
CP-02	5464486.435	359941.549	71.557	49° 19' 01.3215" N	124° 55' 37.8679" W
CP-03	5464987.766	359530.657	74.327	49° 19' 17.2068" N	124° 55' 58.8447" W
CP-04	5465432.080	359257.762	74.404	49° 19' 31.3602" N	124° 56' 12.9200" W
SPIKE	5464578.290	360121.859	70.152	49° 19' 4.4431" N	124° 55' 29.0573" W

- COORDINATES ARE IN NAD 83 UTM ZONE 10.
- BE AWARE OF DAMAGED SURVEY CONTROL MONUMENTS.
- TIE TO TWO OR MORE SURVEY CONTROL MONUMENTS TO CONFIRM ALL COORDINATES AND ELEVATIONS.
- COORDINATES PROVIDED FOR CONVENIENCE ONLY AND TO BE VERIFIED BY CONTRACTOR PRIOR TO CONSTRUCTION.
- THE ENGINEER IS TO BE NOTIFIED OF ANY DISCREPANCIES.

LEGEND

	NON-ILLUMINATED WINDSOCK	
	ILLUMINATED WINDSOCK	
	OVERHEAD POWER	
	POWER CABLES	
	DUCT BANK	
	RUNWAY END LIGHTS	
	RUNWAY EDGE LIGHTS	
	APRON/TAXIWAY EDGE LIGHTS	
	APRON ENTRANCE LIGHTS	

Scale: 1:3,000 @ 22"x34"

NUM	DATE	DWN	CKD	APR	DESCRIPTION	NUM	DATE	APR	DESCRIPTION
1	2015/01/27	T.J.	S.S.	B.K.	UPDATE DRAWING PER CLIENT COMMENTS	B	2015/04/15	B.K.	ISSUED FOR 95% REVIEW
0	2014/11/12	T.J.	S.S.	B.K.	INITIAL DESIGN	A	2015/01/16	B.K.	ISSUED FOR 90% REVIEW

PERMIT

PROFESSIONAL SEAL

CLIENT

ALBERNI-CLAYOQUOT REGIONAL DISTRICT

**RUNWAY EXTENSION DESIGN
ALBERNI VALLEY REGIONAL AIRPORT (CBS8)
PORT ALBERNI, BC**

SURVEY CONTROL PLAN

PROJECT No. C31103399-002	OFFICE CALGARY	DES B.K.	CKD S.S.	REV 1	DRAWING
DATE APRIL 15, 2015	SHEET No. 3 of 3	DWN T.J.	APP B.K.	STATUS A	C1.1

TETRA TECH EBA

G:\21103399\01 Albern Valley Rev EtenPhase 02\Sheet Files\C31103399-01 C1.dwg [C1.1] April 15, 2015 3:48:32 pm BJT-KLUMDIE, B.L.L.

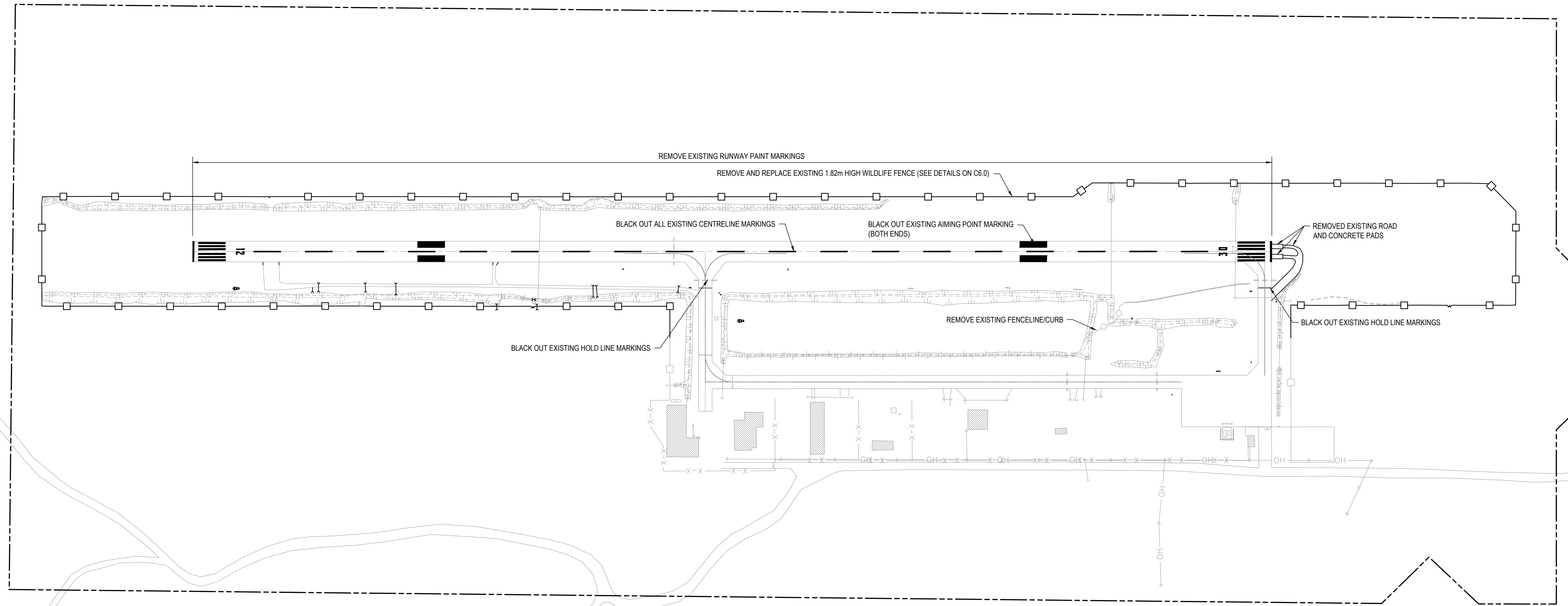
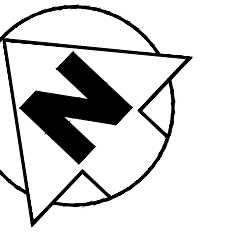

G:\211103399-01\Alberni Valley Rev\ExemptPhase 005\Sheet Files\C31103399-01 22.dwg (C2.0) April 15, 2015 - 3:58:08 pm (BT: KLUMDR, BLL)

LEGEND

	RUNWAY EXTENSION AND WIDENING		NON-ILLUMINATED WINDSOCK		PRECISION APPROACH PATH INDICATOR (PAPI)
	PROPERTY LINE		ILLUMINATED WINDSOCK		AIRPORT ROTATING BEACON
	POST & RAIL WIRE FENCE		OVERHEAD POWER		
	CHAIN LINK SECURITY FENCE		POWER CABLES		
	CHAIN LINK FENCE		DUCT BANK		
	STEEL TUBE FENCE		RUNWAY END LIGHTS		
	TOP OF SLOPE		RUNWAY EDGE LIGHTS		
	TOE OF SLOPE		APRON/TAXIWAY EDGE LIGHTS		
	STORM SEWER LINES		APRON ENTRANCE LIGHTS		
	CULVERTS				

Scale: 1:2,500 @ 22"x34"

NUM	DATE	DWN	CKD	APR	DESCRIPTION	NUM	DATE	APR	DESCRIPTION
1	2015/01/27	T.J.	S.S.	B.K.	UPDATE DRAWING PER CLIENT COMMENTS	B	2015/04/15	B.K.	ISSUED FOR 95% REVIEW
0	2014/11/12	T.J.	S.S.	B.K.	INITIAL DESIGN	A	2015/01/16	B.K.	ISSUED FOR 90% REVIEW

PERMIT

PROFESSIONAL SEAL

CLIENT

ALBERNI-CLAYOQUOT REGIONAL DISTRICT

TETRA TECH EBA

RUNWAY EXTENSION DESIGN ALBERNI VALLEY REGIONAL AIRPORT (CBS8) PORT ALBERNI, BC

DEMOLITION PLAN

PROJECT No.	OFFICE	DES	CKD	REV	DRAWING
C31103399-002	CALGARY	B.K.	S.S.	1	
DATE:	SHEET No.	DWN	APP	STATUS	
APRIL 15, 2015	4 of	T.J.	B.K.	A	C2.0

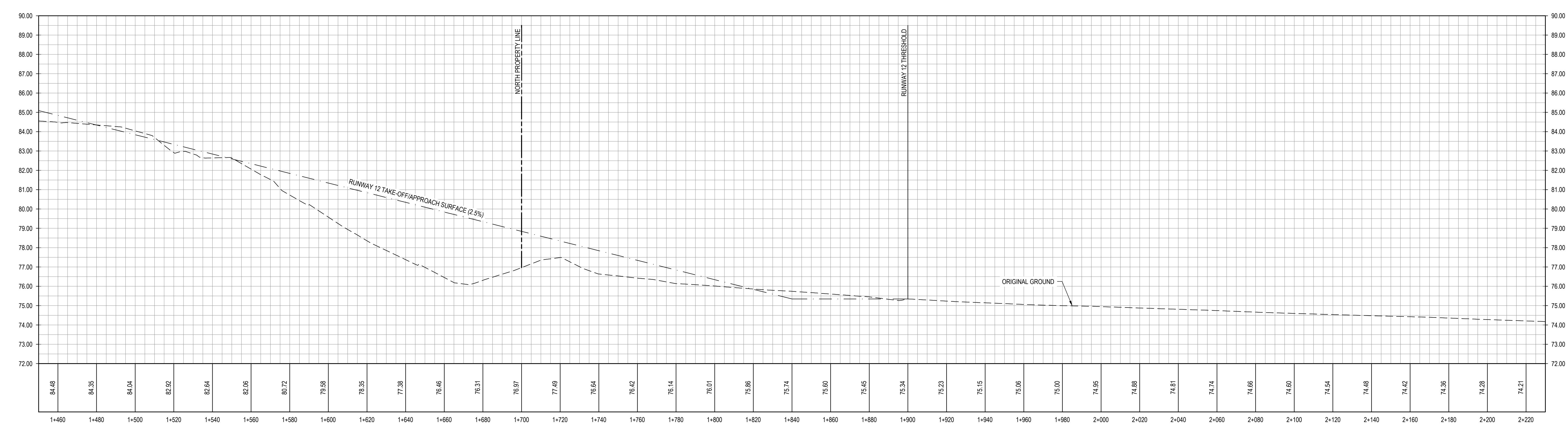
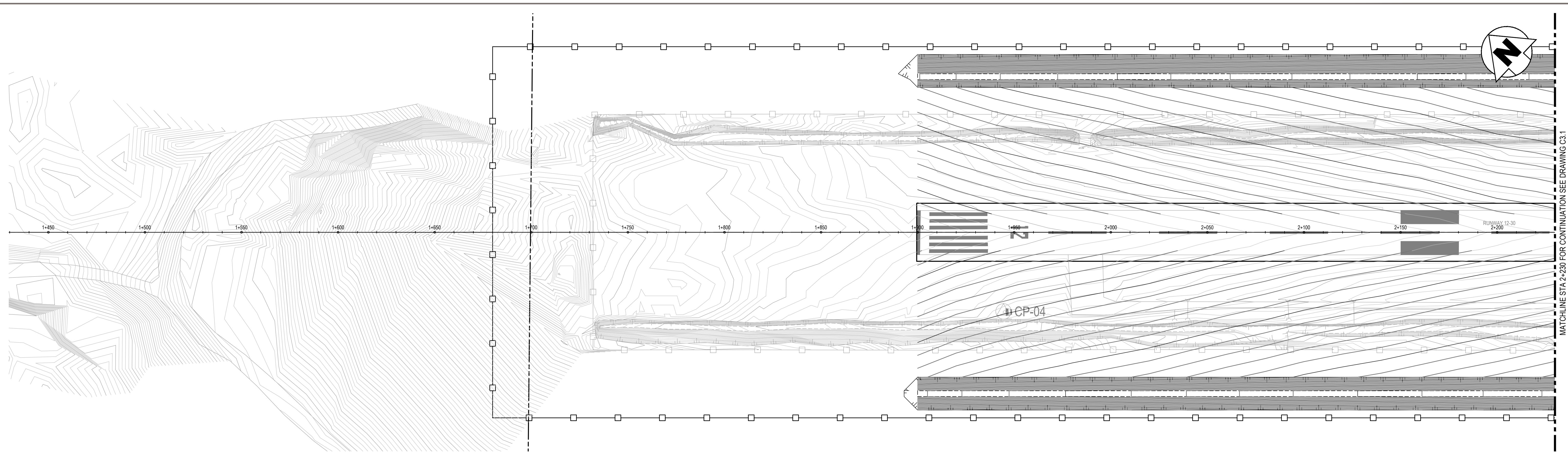

LEGEND

---+---	RUNWAY EXTENSION AND WIDENING		NON-ILLUMINATED WINDSOCK		PRECISION APPROACH PATH INDICATOR (PAPI)
---	PROPERTY LINE		ILLUMINATED WINDSOCK		AIRPORT ROTATING BEACON
-□-	POST & RAIL FENCE	-DH-	OVERHEAD POWER		
-X-X-	CHAIN LINK SECURITY FENCE	- - - - -	POWER CABLES		
-X-	CHAIN LINK FENCE	- - - - -	DUCT BANK		
-○-	STEEL TUBE FENCE	●	RUNWAY END LIGHTS		
-H-H-	TOP OF SLOPE	○	RUNWAY EDGE LIGHTS		
- - - - -	TOE OF SLOPE	○	APRON/TAXIWAY EDGE LIGHTS		
-ST-	STORM SEWER LINES	⊕	APRON ENTRANCE LIGHTS		
-) (-	CULVERTS				

NUM	DATE	DWN	CKD	APR	DESCRIPTION	NUM	DATE	APR	DESCRIPTION
1	2015/01/27	T.J.	S.S.	B.K.	UPDATE DRAWING PER CLIENT COMMENTS	B	2015/04/15	B.K.	ISSUED FOR 95% REVIEW
0	2014/11/12	T.J.	S.S.	B.K.	INITIAL DESIGN	A	2015/01/16	B.K.	ISSUED FOR 90% REVIEW

	CLIENT ALBERNI-CLAYOQUOT REGIONAL DISTRICT	PROJECT No. C31103399-002	OFFICE CALGARY	DES B.K.	CKD S.S.	REV 1	DRAWING STATUS
	PERMIT	PROFESSIONAL SEAL	DATE: APRIL 15, 2015	SHEET No.: 5 of 5	DWN T.J.	APP B.K.	STATUS A

RUNWAY EXTENSION DESIGN
ALBERNI VALLEY REGIONAL AIRPORT (CBS8)
PORT ALBERNI, BC

RUNWAY PLAN & PROFILE
STA 1+450 TO STA 2+230

C3.0

G:\21103399\01 Alberni Valley Rev. E\m\phase005\Sheet Files\C31103399-01.dwg (C3.0) April 15, 2015 - 4:19:49 pm (BT: KLUMOR, BLL)

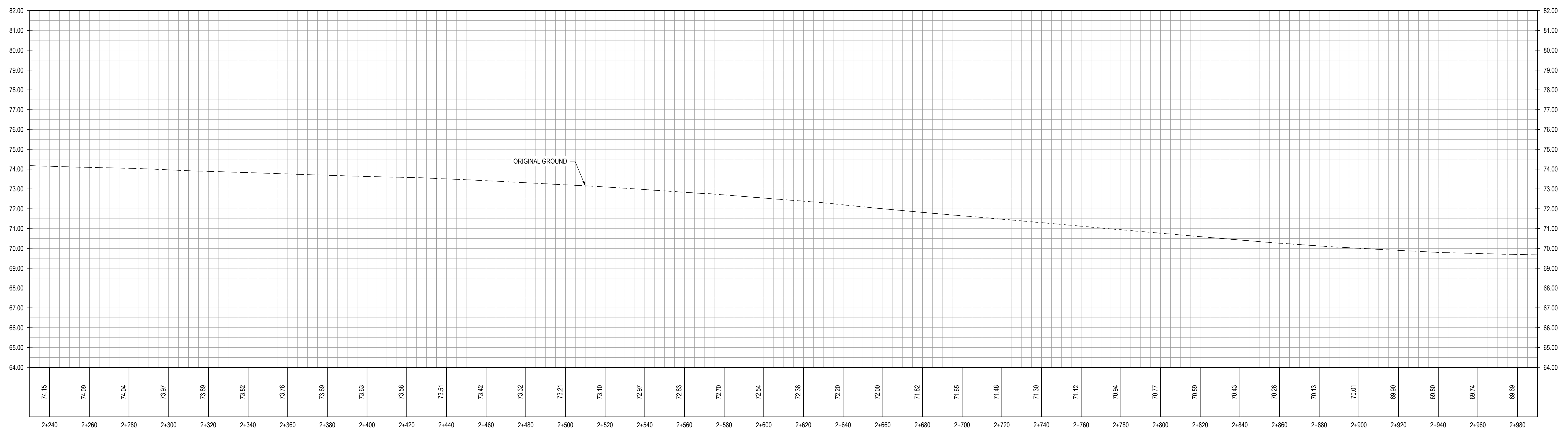
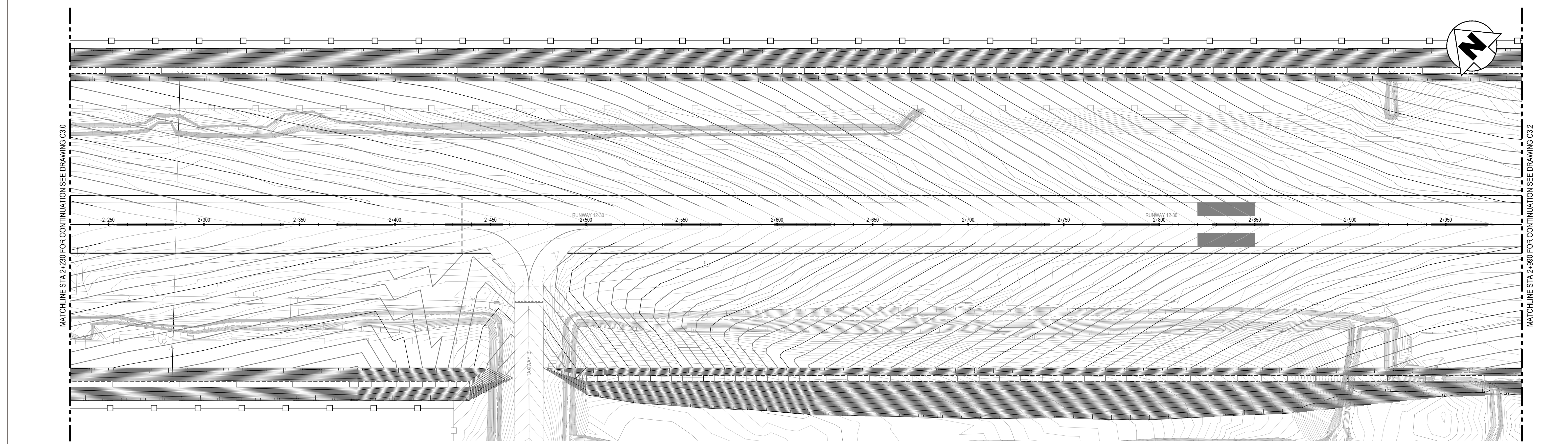

C:\21103399-01\Albemi Valley Rev\ExtensPhase\02\Sheet Files\C31\C31.dwg (C31) April 15, 2015 - 4:12:25 pm (BT: KLUMOR, BLL)

LEGEND

	RUNWAY EXTENSION AND WIDENING		NON-ILLUMINATED WINDSOCK		PRECISION APPROACH PATH INDICATOR (PAPI)
	PROPERTY LINE		ILLUMINATED WINDSOCK		AIRPORT ROTATING BEACON
	POST & PAGE WIRE FENCE		OVERHEAD POWER		
	CHAIN LINK SECURITY FENCE		POWER CABLES		
	CHAIN LINK FENCE		DUCT BANK		
	STEEL TUBE FENCE		RUNWAY END LIGHTS		
	TOP OF SLOPE		RUNWAY EDGE LIGHTS		
	TOE OF SLOPE		APRON/TAXIWAY EDGE LIGHTS		
	STORM SEWER LINES		APRON ENTRANCE LIGHTS		
	CULVERTS				

Vertical Scale: 1:100
 Horizontal Scale: 1:1,000 @ 22"x34"

NUM	DATE	DWN	CKD	APR	DESCRIPTION	NUM	DATE	APR	DESCRIPTION
1	2015/01/27	T.J.	S.S.	B.K.	UPDATE DRAWING PER CLIENT COMMENTS	B	2015/04/15	B.K.	ISSUED FOR 95% REVIEW
0	2014/11/12	T.J.	S.S.	B.K.	INITIAL DESIGN	A	2015/01/16	B.K.	ISSUED FOR 90% REVIEW

REVISIONS

DRAWING STATUS

PERMIT

PROFESSIONAL SEAL

CLIENT

ALBERNI-CLAYOQUOT REGIONAL DISTRICT

**RUNWAY EXTENSION DESIGN
ALBERNI VALLEY REGIONAL AIRPORT (CBS8)
PORT ALBERNI, BC**

**RUNWAY PLAN & PROFILE
STA 2+230 TO STA 2+990**

PROJECT No. C31103399-002	OFFICE CALGARY	DES B.K.	CKD S.S.	REV 1	DRAWING STATUS
DATE APRIL 15, 2015	SHEET No. 6 of 6	DWN T.J.	APP B.K.	STATUS A	C3.1

TETRA TECH EBA

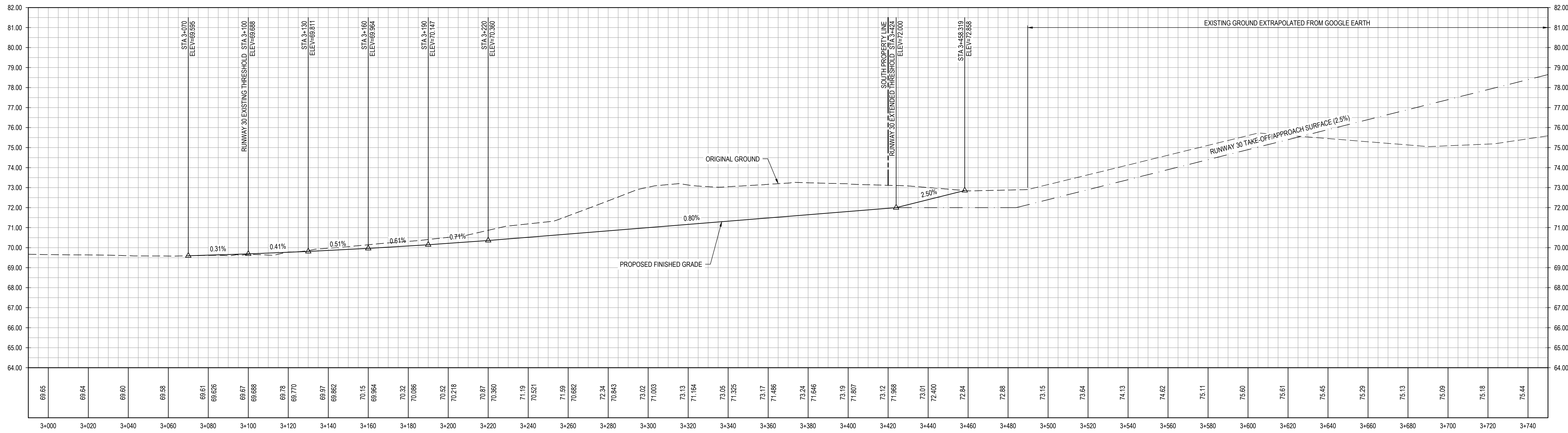
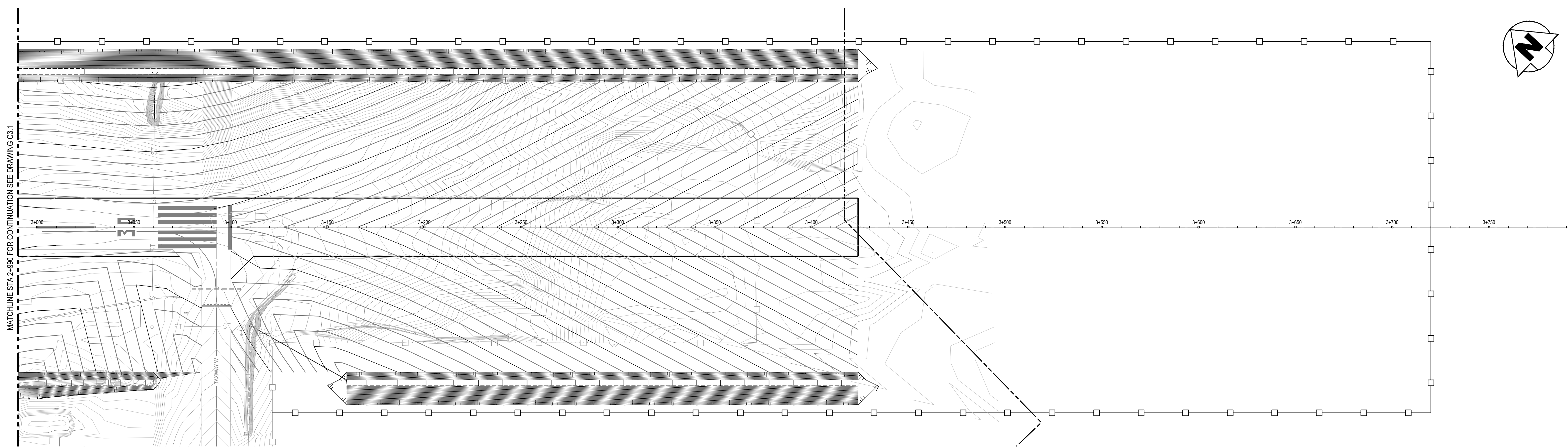
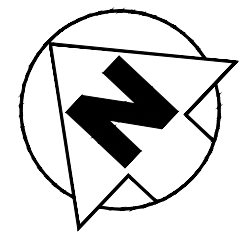

G:\21103399-01\Albemi Valley Rev\ExtensPhase005\Sheet Files\C3103399-01 C3.2.dwg (C3.2) April 15, 2015 4:17:12 pm (B:\KLUMDIB, BLL)

LEGEND

<ul style="list-style-type: none"> --- RUNWAY EXTENSION AND WIDENING - - - PROPERTY LINE □ POST & PAGE WIRE FENCE -X-X- CHAIN LINK SECURITY FENCE -X- CHAIN LINK FENCE ○ STEEL TUBE FENCE --- TOP OF SLOPE - - - TOE OF SLOPE --- ST --- STORM SEWER LINES --- CULVERTS 	<ul style="list-style-type: none"> NON-ILLUMINATED WINDSOCK ILLUMINATED WINDSOCK OH OVERHEAD POWER --- POWER CABLES --- DUCT BANK ● RUNWAY END LIGHTS ○ RUNWAY EDGE LIGHTS ○ APRON/TAXIWAY EDGE LIGHTS ○ APRON ENTRANCE LIGHTS 	<ul style="list-style-type: none"> □ PRECISION APPROACH PATH INDICATOR (PAPI) ⊙ AIRPORT ROTATING BEACON
---	---	---

Vertical Scale: 1:100
Horizontal Scale: 1:1,000 @ 22"x34"

NUM	DATE	DWN	CKD	APR	DESCRIPTION	NUM	DATE	APR	DESCRIPTION
1	2015/01/27	T.J.	S.S.	B.K.	UPDATE DRAWING PER CLIENT COMMENTS	B	2015/04/15	B.K.	ISSUED FOR 95% REVIEW
0	2014/11/12	T.J.	S.S.	B.K.	INITIAL DESIGN	A	2015/01/16	B.K.	ISSUED FOR 90% REVIEW

REVISIONS **DRAWING STATUS**

PERMIT

PROFESSIONAL SEAL

CLIENT

ALBERNI-CLAYOQUOT REGIONAL DISTRICT

**RUNWAY EXTENSION DESIGN
ALBERNI VALLEY REGIONAL AIRPORT (CBS8)
PORT ALBERNI, BC**

**RUNWAY PLAN & PROFILE
STA 2+990 TO STA 3+750**

PROJECT No. C31103399-002	OFFICE CALGARY	DES B.K.	CKD S.S.	REV 1	DRAWING STATUS A
DATE APRIL 15, 2015	SHEET No. 7 of	DWN T.J.	APP B.K.	STATUS A	C3.2

TETRA TECH EBA

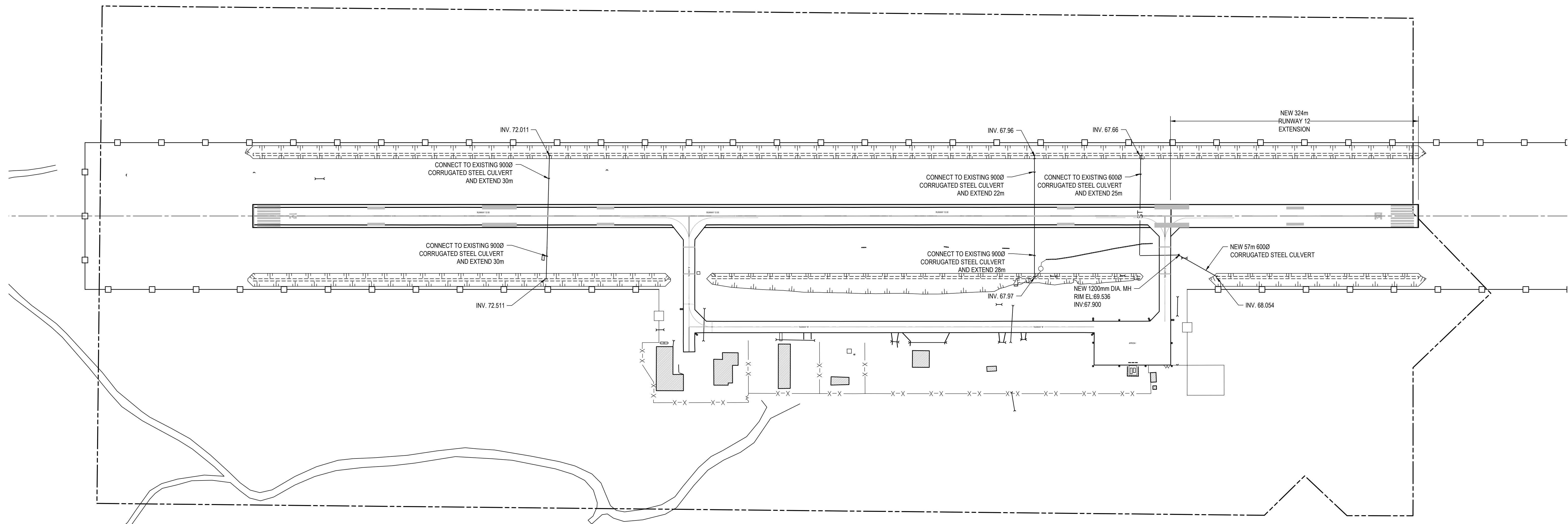
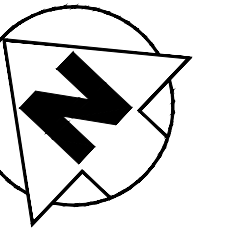

C:\21103399-01\Alberni Valley Rev\ExtensPhase005\Sheet Files\C31103399-01 25.0.dwg (CSG) April 15, 2015 4:25:42 pm (BY: KLUMDOR, BLL)

LEGEND

	RUNWAY EXTENSION AND WIDENING		NON-ILLUMINATED WINDSOCK		PRECISION APPROACH PATH INDICATOR (PAPI)
	PROPERTY LINE		ILLUMINATED WINDSOCK		AIRPORT ROTATING BEACON
	POST & RAIL WIRE FENCE		OVERHEAD POWER		
	CHAIN LINK SECURITY FENCE		POWER CABLES		
	CHAIN LINK FENCE		DUCT BANK		
	STEEL TUBE FENCE		RUNWAY END LIGHTS		
	TOP OF SLOPE		RUNWAY EDGE LIGHTS		
	TOE OF SLOPE		APRON/TAXIWAY EDGE LIGHTS		
	STORM SEWER LINES		APRON ENTRANCE LIGHTS		
	CULVERTS				

Scale: 1:2,500 @ 22"x34"

NUM	DATE	DWN	CKD	APR	DESCRIPTION	NUM	DATE	APR	DESCRIPTION
1	2015/01/27	T.J.	S.S.	B.K.	UPDATE DRAWING PER CLIENT COMMENTS	B	2015/04/15	B.K.	ISSUED FOR 95% REVIEW
0	2014/11/12	T.J.	S.S.	B.K.	INITIAL DESIGN	A	2015/01/16	B.K.	ISSUED FOR 90% REVIEW

REVISIONS

DRAWING STATUS

PERMIT

PROFESSIONAL SEAL

CLIENT

ALBERNI-CLAYOQUOT REGIONAL DISTRICT

TETRA TECH EBA

RUNWAY EXTENSION DESIGN ALBERNI VALLEY REGIONAL AIRPORT (CBS8) PORT ALBERNI, BC

OVERALL DRAINAGE PLAN

PROJECT No.	OFFICE	DES	CKD	REV	DRAWING
C31103399-002	CALGARY	B.K.	S.S.	1	
DATE:	SHEET No.	DWN	APP	STATUS	
APRIL 15, 2015	15 of	T.J.	B.K.	A	C5.0

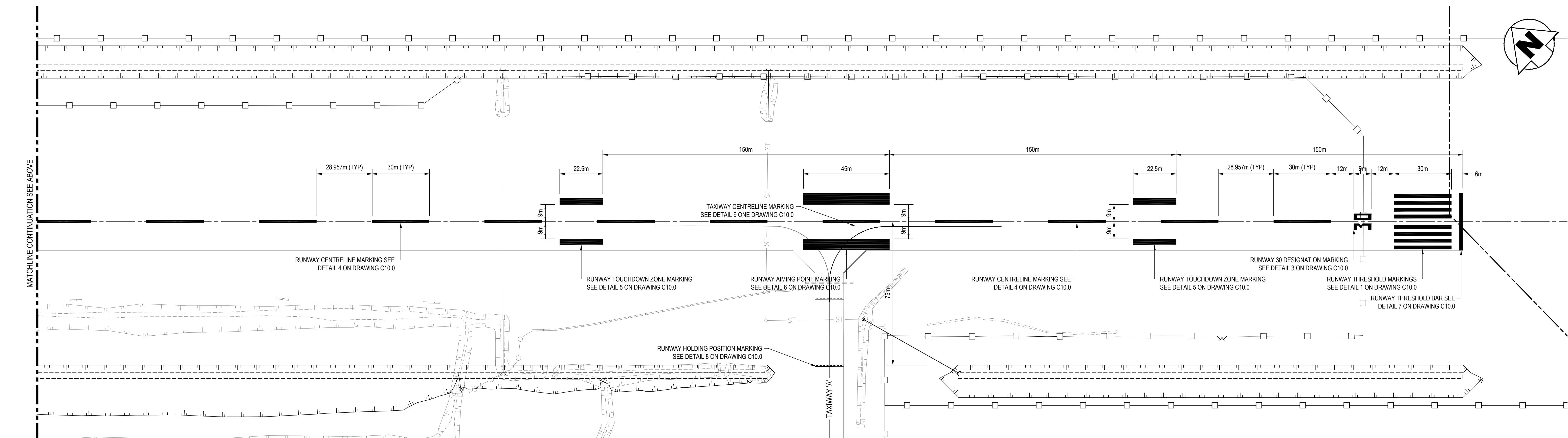
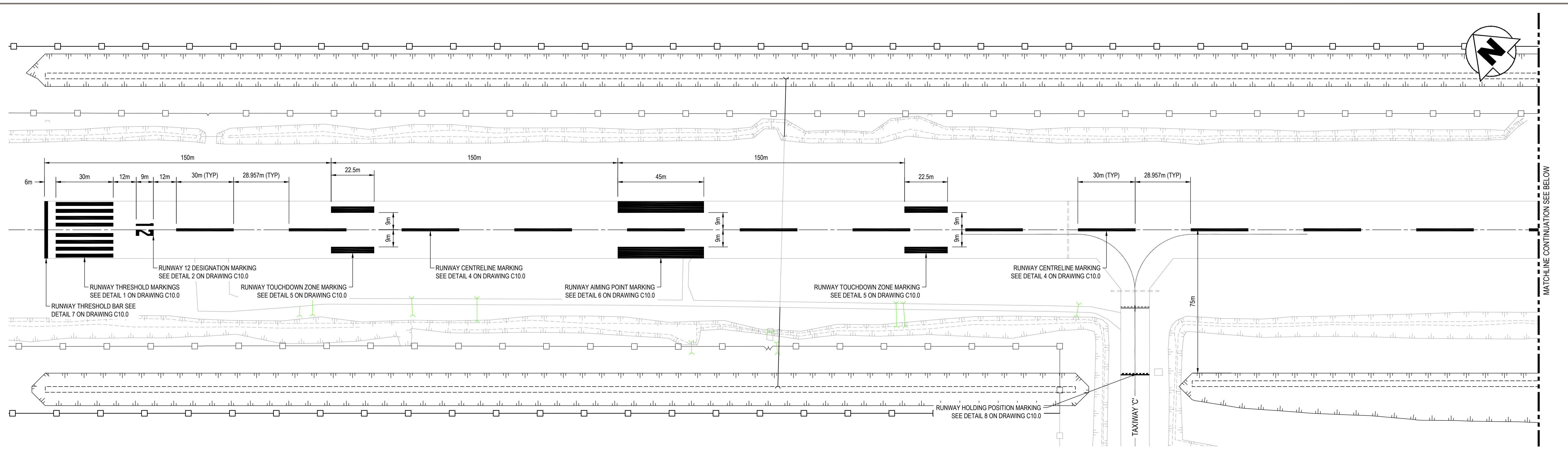

LEGEND

- Runway Extension and Widening
- Property Line
- Post & Page Wire Fence
- Chain Link Security Fence
- Chain Link Fence
- Steel Tube Fence
- Top of Slope
- Toe of Slope
- ST - Storm Sewer Lines
- Culverts
- Non-Illuminated Windsock
- Illuminated Windsock
- Overhead Power
- Power Cables
- Duct Bank
- Runway End Lights
- Runway Edge Lights
- Apron/Taxiway Edge Lights
- Apron Entrance Lights
- Precision Approach Path Indicator (PAPI)
- Airport Rotating Beacon

Scale: 1:1,000 @ 22"x34"

NUM	DATE	DWN	CKD	APR	DESCRIPTION	NUM	DATE	APR	DESCRIPTION
1	2015/01/27	T.J.	S.S.	B.K.	UPDATE DRAWING PER CLIENT COMMENTS	B	2015/04/15	B.K.	ISSUED FOR 95% REVIEW
0	2014/11/12	T.J.	S.S.	B.K.	INITIAL DESIGN	A	2015/01/16	B.K.	ISSUED FOR 90% REVIEW

REVISIONS

NUM	DATE	DWN	CKD	APR	DESCRIPTION

DRAWING STATUS

PERMIT

PROFESSIONAL SEAL

CLIENT

ALBERNI-CLAYOQUOT REGIONAL DISTRICT

TETRA TECH EBA

RUNWAY EXTENSION DESIGN ALBERNI VALLEY REGIONAL AIRPORT (CBS8) PORT ALBERNI, BC

PAINT MARKING PLAN

PROJECT No.	OFFICE	DES	CKD	REV	DRAWING
C31103399-002	CALGARY	B.K.	S.S.	1	

DATE	SHEET No.	DWN	APP	STATUS
APRIL 15, 2015	19 of	T.J.	B.K.	A

C9.0

C:\21103399-01\Alberni Valley Rev\ExtensPhase002\Sheet Files\C31103399-01_C9.0.dwg (C9.0) April 15, 2015 4:37:24 pm (B.K., KLUMBER, B.L.)